

8 7 6 5 4 3 2 1

F
E
D
C
B
A

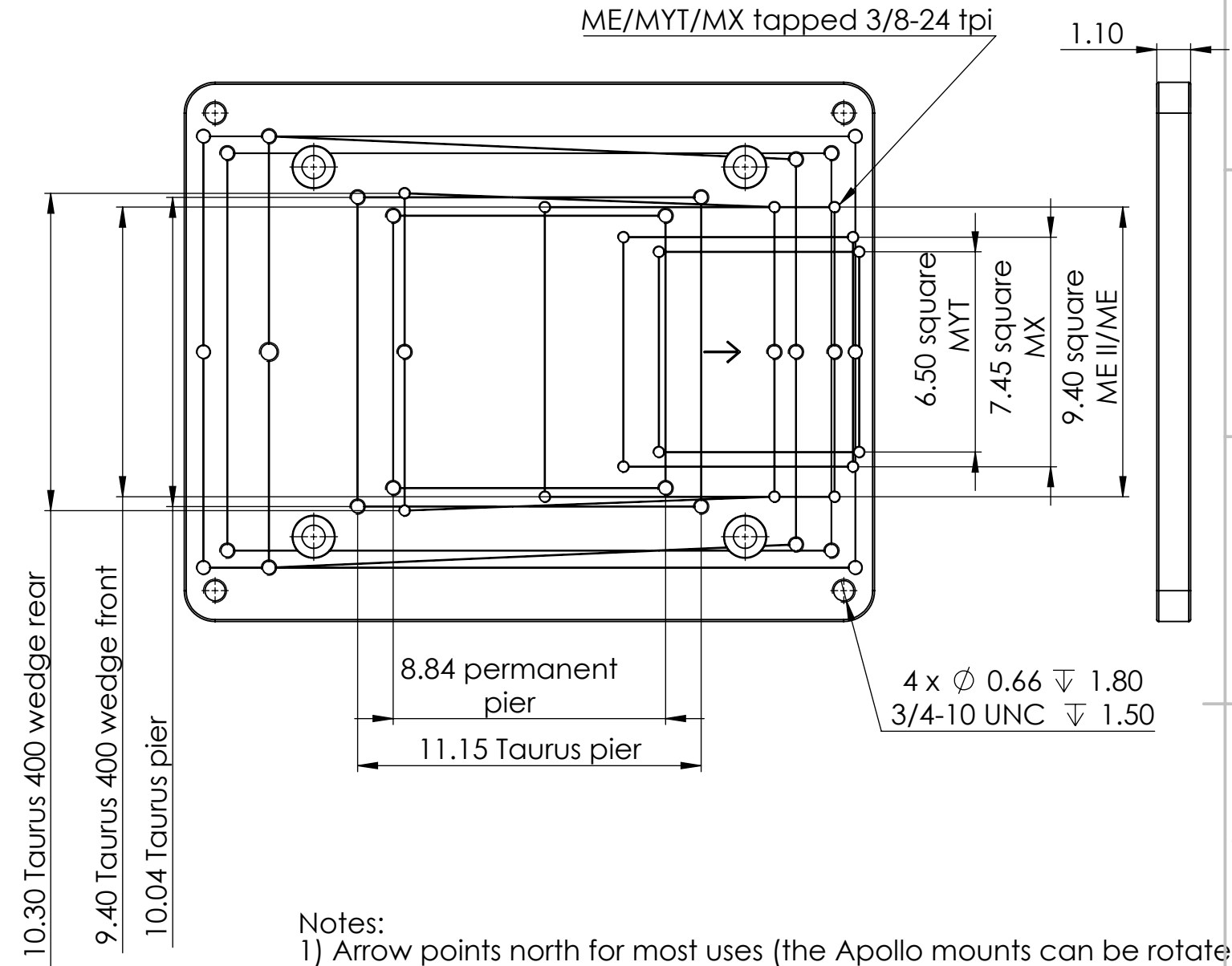

- Notes:
- 1) Arrow points north for most uses (the Apollo mounts can be rotated 90 degrees).
 - 2) The plate is fastened to the ground using 4 bolts 1/2 or 5/8 inch (see mounting c bore) holding the plate to the ground, while there are 4 leveling set screws on the outside corners (3/4-10 tpi) for a push-pull system.
 - 3) The plate weighs 35 lbs (16 kg).

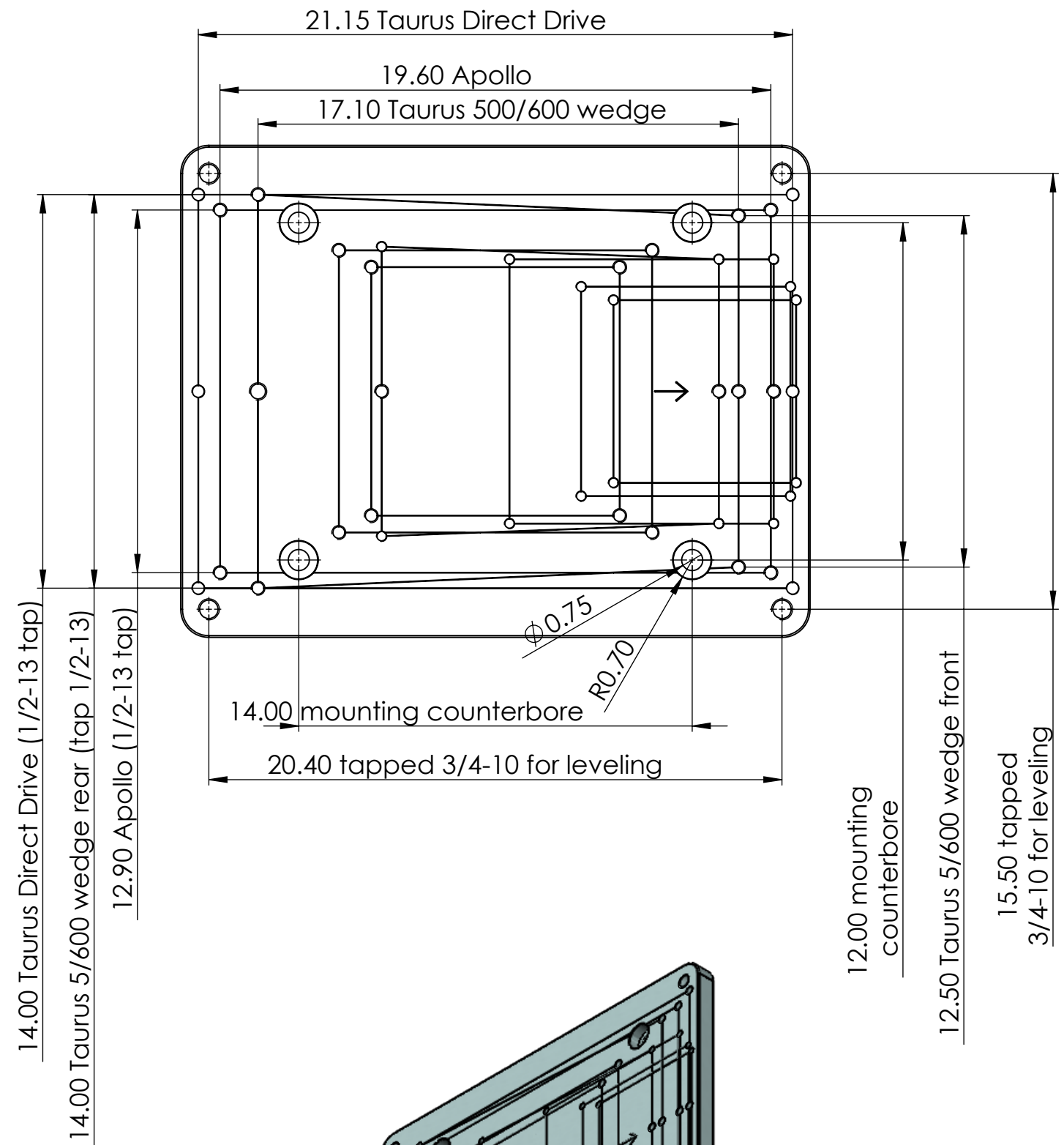
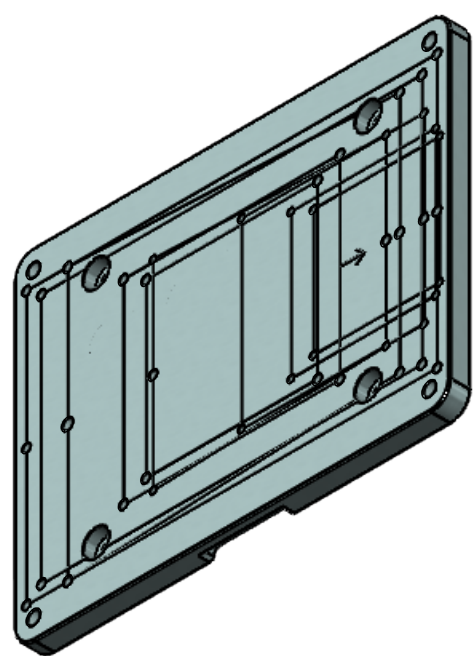

SB
SOFTWARE BISQUE
PROPRIETARY AND CONFIDENTIAL

Stock Size	
Surface Area	in ²
Weight	lbs
Anodize	
No Per Mount	

DIMENSIONS ARE IN INCHES
TOLERANCES:
THREE PLACE DECIMAL
±

MATERIAL

FINISH

DO NOT SCALE DRAWING

Software Bisque

Part Number:
MP 560

Part Name:
universal adapter for SB mounts

SIZE DWG. NO. **A** Rev

Date last edited: 1/29/2021

SHEET 2 OF 2

8 7 6 5 4 3 2 1